

Disclaimer: This map is intended for information purposes only and was compiled from a variety of sources. Omissions and errors may exist. This map contains best available GIS information at the time of publishing.

Map SDPRLamird10-b  
**SEQUIM BAY LODGE**  
**PARCEL SIZE AND 2005 BUILD-OUT**  
 Prepared by Clallam County Dep't of Community Development,  
 EDITS: CTT, June 21, 2006

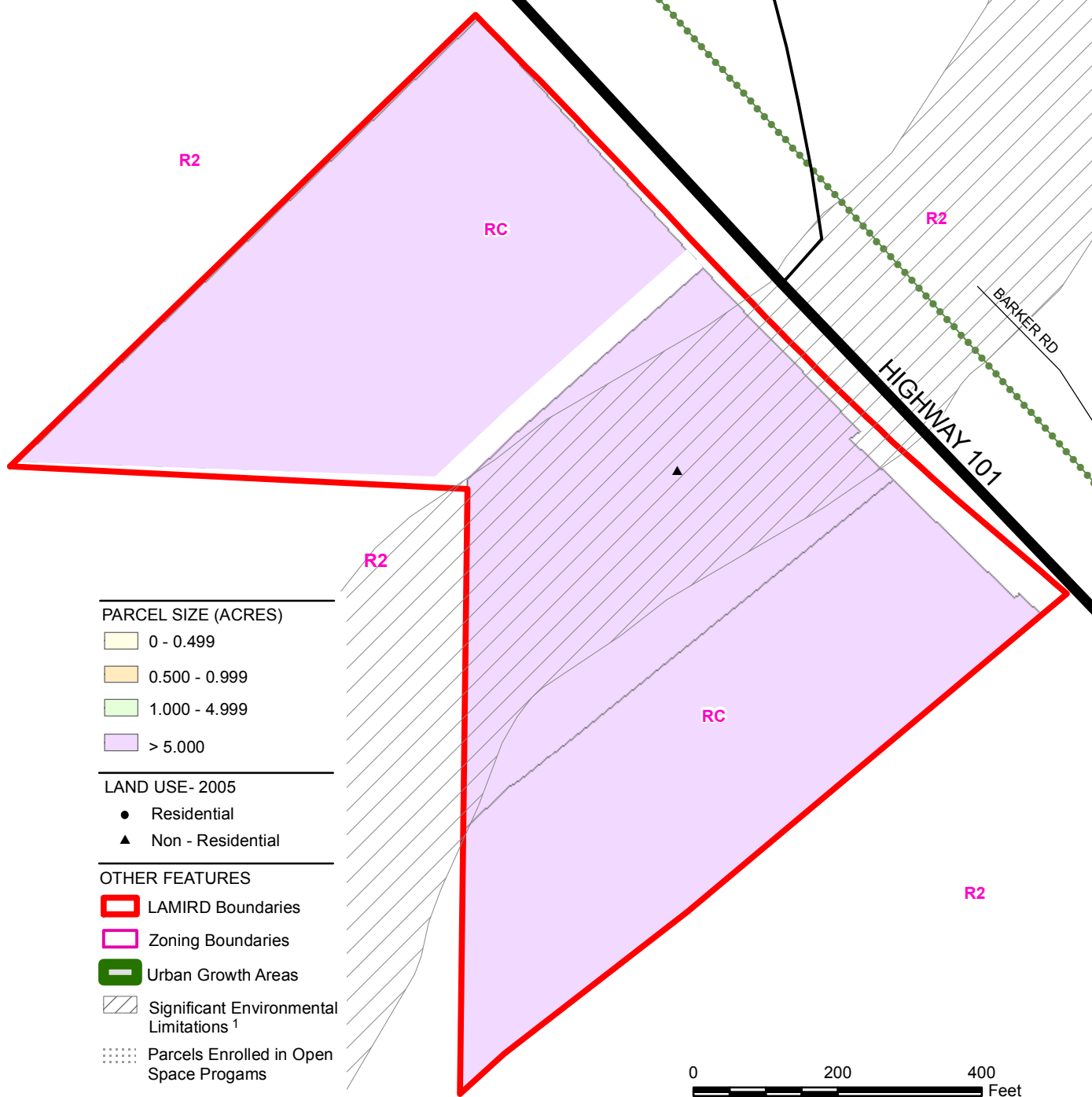

- PARCEL SIZE (ACRES)**
- 0 - 0.499
  - 0.500 - 0.999
  - 1.000 - 4.999
  - > 5.000
- LAND USE - 2005**
- Residential
  - ▲ Non - Residential
- OTHER FEATURES**
- ▭ LAMIRD Boundaries
  - ▭ Zoning Boundaries
  - ▭ Urban Growth Areas
  - ▨ Significant Environmental Limitations <sup>1</sup>
  - ▨ Parcels Enrolled in Open Space Programs
  - Olympic Discovery Trail

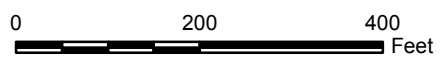

1- Includes approximate location of wetlands, waterbodies, landslide hazard areas, 100-year floodplain areas, and associated protective buffers (estimated width) regulated by the Clallam County Critical Areas Ordinance, CCC 27.12.

