

Map PAP1amird7-b

LAKE FARM

PARCEL SIZE AND 2005 BUILD-OUT

Prepared by Clallam County Dep't of Community Development,
August 7, 2008

PARCEL SIZE (ACRES)

- 0 - 0.999
- 1.000 - 1.999
- 2.000 - 4.999
- >5,000

OTHER FEATURES

- Deleted LAMIRD Boundaries
- LAMIRD Boundaries
- Zoning Boundaries
- Significant Environmental Limitations¹

LAND USE - 2005

- Residential
- Non - Residential

1. Includes approximate location of wetlands, waterbodies, landslide hazard areas, 100-year floodplain areas, and associated protective buffers (estimated width) regulated by the Clallam County Critical Areas Ordinance, CCC 27.12.

- Parcels Enrolled in Open Space Programs
- Olympic Discovery Trail

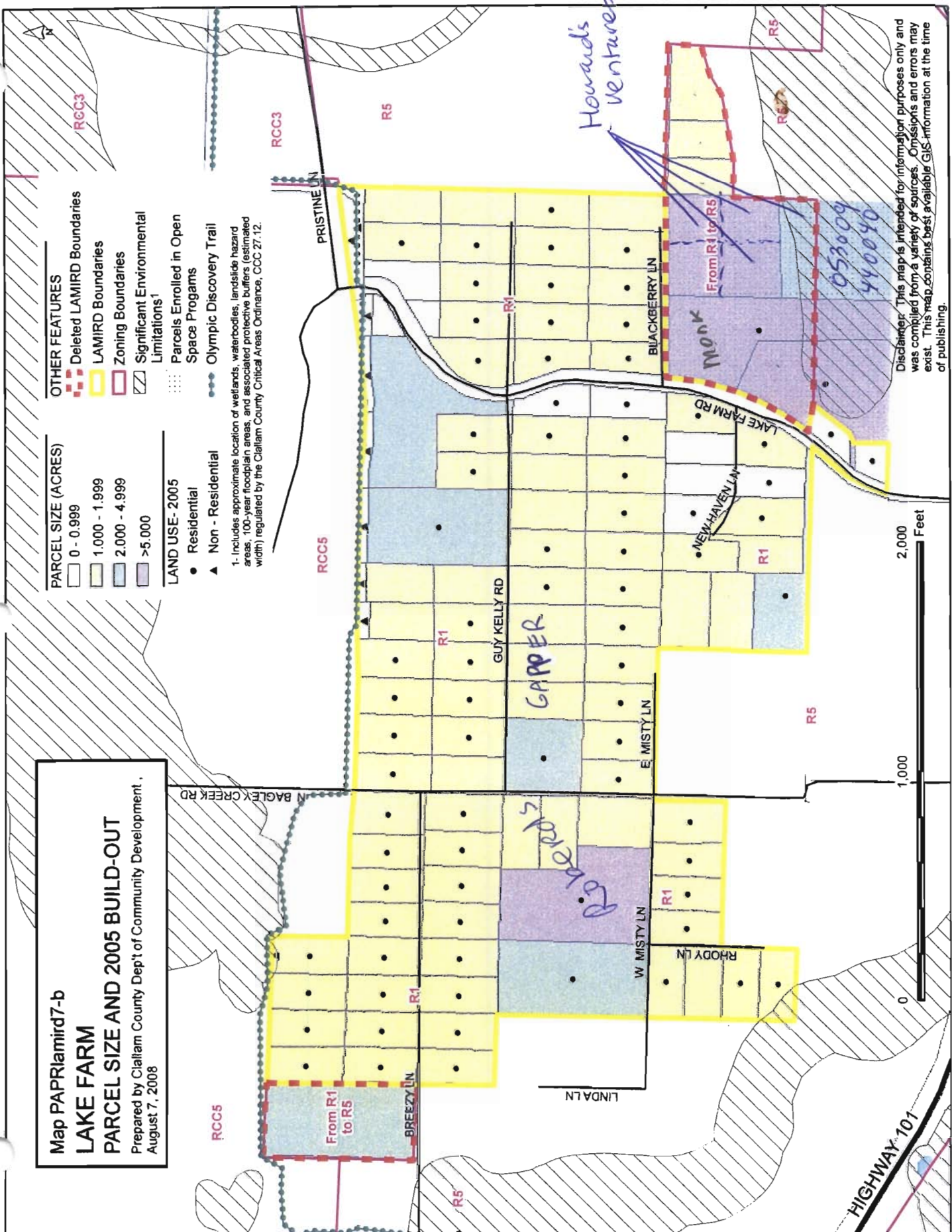

Disclaimer: This map is intended for informational purposes only and was compiled from a variety of sources. Omissions and errors may exist. This map contains best available GIS information at the time of publishing.

cl

Breitbach, Tami

From: Barbara GAPPER [thegapp@msn.com]
Sent: Sunday, September 14, 2008 9:29 AM
To: Breitbach, Tami
Subject: Comments on zoning change

This is in regards to: Map PAPRIamirid7-b
Lake Farm
Parcel Size and Build-out
Prepared August 7, 2008

Change 24 acres from R-1 to R-5 zoning.

I live on Guy Kelly Road close to the affected area. **I am firmly in favor of changing it to the R-5 designation.** I have watched this area grow from the 4 homes that were here when I moved here in 1991 to over 19 just on Guy Kelly going west of Lake Farm to Bagely Creek Road. Anything to keep a less dense designation, especially around Kelly Pond.

Thank you. Barbara J. Gapper

DL34

C

Breitbach, Tami

From: doug monk [bet-sea@hotmail.com]
Sent: Thursday, September 11, 2008 12:55 PM
To: Breitbach, Tami
Subject: WWGMHB decision

Hello My name is Doug Monk and I own 5.78 acres on lake farm, a parcel that is effected by the new zoning laws that don't seem to be new just misinterpreted ,anyway there is nothing I can say or do that is going to change the decision that is made so I will express the effect this has on my life and my plans for that property .I am a fishermen and don't have a retirement plan so all my extra money has gone into property, my plan was to subdivide and sell it for my retirement. let me explain this in numbers,a one acre parcel right beside mine sold for 198,000. at the peak of the property sales I have looked into subdividing my property with the set backs I had enough for 3 parcels. my property is surrounded by one acre parcels, so I am punished for not hastily exploiting my property? I just hope the county doesn't step in and take a lions share of your retirement for the good of the community thank you for your time

Doug Monk

DL35

9/15/2008